

SEATING TABULATION

SECTION 101 SEAT COUNTS:	= 372 ULTIMATE FLIP-UP FLOORTRACK = 86 BRAVO FLOORTRACK = 20 WHEELCHAIR W/ 20 COMP. SEATS = 498 TOTAL SEATS
SECTION 102 SEAT COUNTS:	= 459 ULTIMATE FLIP-UP FLOORTRACK = 189 BRAVO FLOORTRACK = 648 TOTAL SEATS
SECTION 103 SEAT COUNTS;	= 372 ULTIMATE FLIP-UP FLOORTRACK = 86 BRAVO FLOORTRACK = 20 WHEELCHAIR W/ 20 COMP. SEATS = 498 TOTAL SEATS
SECTION 104 SEAT COUNTS:	= 692 ULTIMATE FLIP-UP FLOORTRACK = 692 TOTAL SEATS
SECTION 105 SEAT COUNTS:	= 270 ULTIMATE FLIP-UP FLOORTRACK = 270 TOTAL SEATS
SECTION 106 SEAT COUNTS:	= 692 ULTIMATE FLIP-UP FLOORTRACK = 692 TOTAL SEATS
SECTION 107 SEAT COUNTS:	= 274 ULTIMATE FLIP-UP FLOORTRACK = 274 TOTAL SEATS
SECTION 108 SEAT COUNTS:	= 274 ULTIMATE FLIP-UP FLOORTRACK = 274 TOTAL SEATS
STAND A SEAT COUNTS:	= 768 ULTIMATE FLIP-UP SEATS = 1,742 ULTIMATE BENCH SEATS = 13 WHEELCHAIRS & 13 COMPANION SEATS = 2,536 TOTAL SEATS
STAND B SEAT COUNTS:	= 402 ULTIMATE FLIP-UP SEATS = 411 ULTIMATE BENCH SEATS = 813 TOTAL SEATS
STAND C SEAT COUNTS:	= 402 ULTIMATE FLIP-UP SEATS = 870 ULTIMATE BENCH SEATS = 1,272 TOTAL SEATS
SUITES	= 90 SEATS
HATCHED MITER SEATING	= APPROX. 50 SEATS PER MITER = (APPROX. 100 TOTAL)
TOTAL SEAT COUNTS:	= 5,014 TOTAL ULTIMATE FLIP-UP SEATS = 2,840 TOTAL ULTIMATE BENCH SEATS = 361 TOTAL BRAVO SEATS = 53 TOTAL WHEELCHAIR SEATS = 53 TOTAL COMP. SEATS = 90 TOTAL SUITES
OVERALL TOTAL SEAT COUNT	= 8,598 SEATS

RESTROOMS

INSIDE VENUE	= 120
OUTSIDE VENUE	= 30
TOTAL	= 150

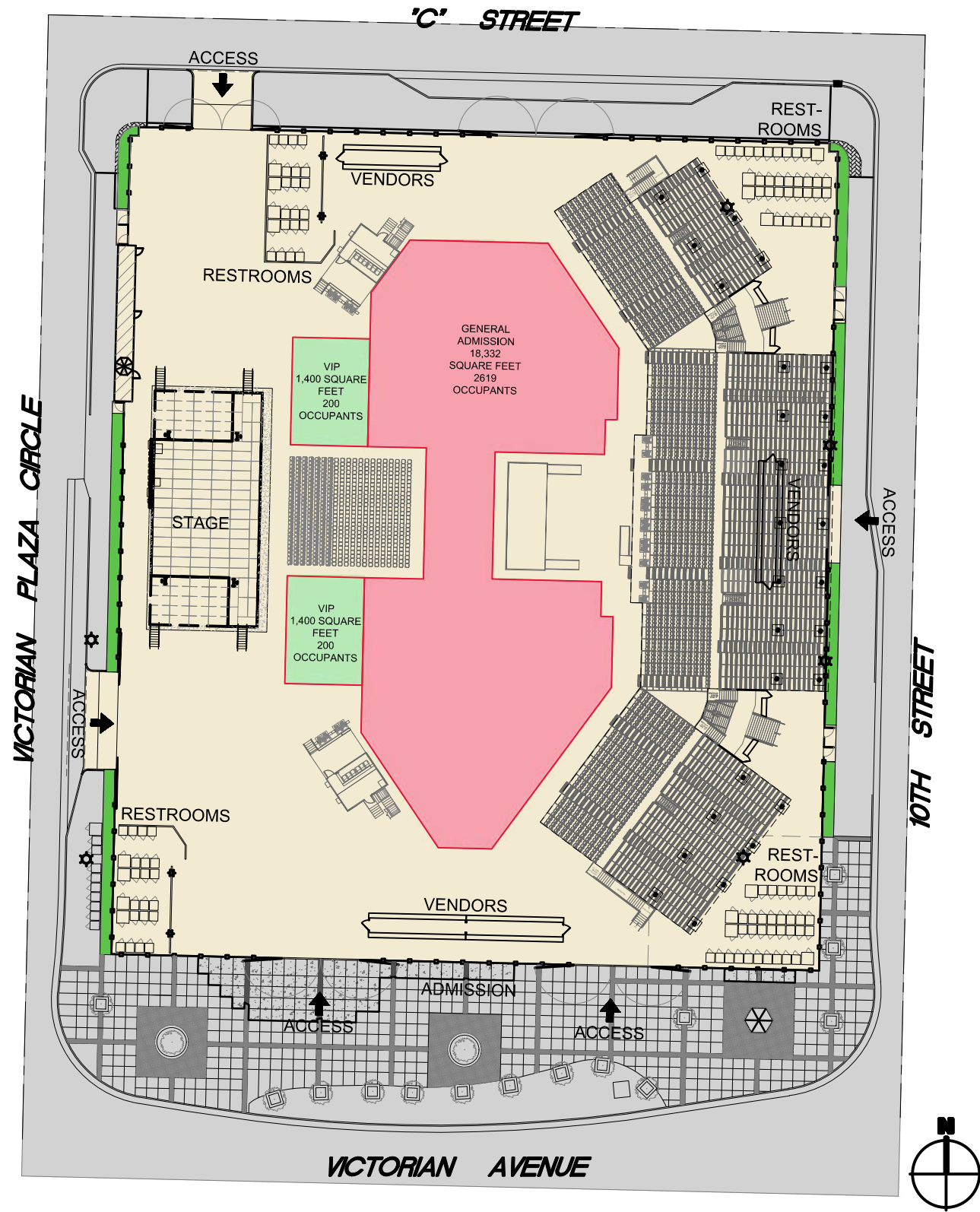

SEATING TABULATION

SECTION 101 SEAT COUNTS:	= 351 ULTIMATE FLIP-UP FLOORTRACK
	= 189 BRAVO FLOORTRACK
	= 540 TOTAL SEATS
STAND A SEAT COUNTS:	= 768 ULTIMATE FLIP-UP SEATS
	= 1,742 ULTIMATE BENCH SEATS
	= 13 WHEELCHAIRS & 13 COMPANION SEATS
	= 2,536 TOTAL SEATS
STAND B SEAT COUNTS:	= 402 ULTIMATE FLIP-UP SEATS
	= 411 ULTIMATE BENCH SEATS
	= 813 TOTAL SEATS
STAND C SEAT COUNTS:	= 402 ULTIMATE FLIP-UP SEATS
	= 870 ULTIMATE BENCH SEATS
	= 1,272 TOTAL SEATS
HATCHED MITER SEATING:	= APPROX. 50 SEATS PER MITER
	= (APPROX. 100 TOTAL)
VIP GA 1 OCCUPANCY:	= 200 GA
VIP GA 2 OCCUPANCY:	= 200 GA
GENERAL ADMISSION:	= 2,600 GA
SUITES	= 90
TOTAL SEAT/ TICKET COUNTS:	= 1,923 TOTAL ULTIMATE FLIP-UP SEATS
	= 3,023 TOTAL ULTIMATE BENCH SEATS
	= 189 TOTAL BRAVO SEATS
	= 13 TOTAL WHEELCHAIR SEATS
	= 13 TOTAL COMP. SEATS
	= 90 TOTAL SUITES
	= 100 MITER SEATS
	= 2,619 GENERAL ADMISSION
	= 400 VIP GENERAL ADMISSION
OVERALL TOTAL SEAT COUNT	= 8,370 SEATS

RESTROOMS

INSIDE VENUE	= 120
OUTSIDE VENUE	= 30
TOTAL	= 150

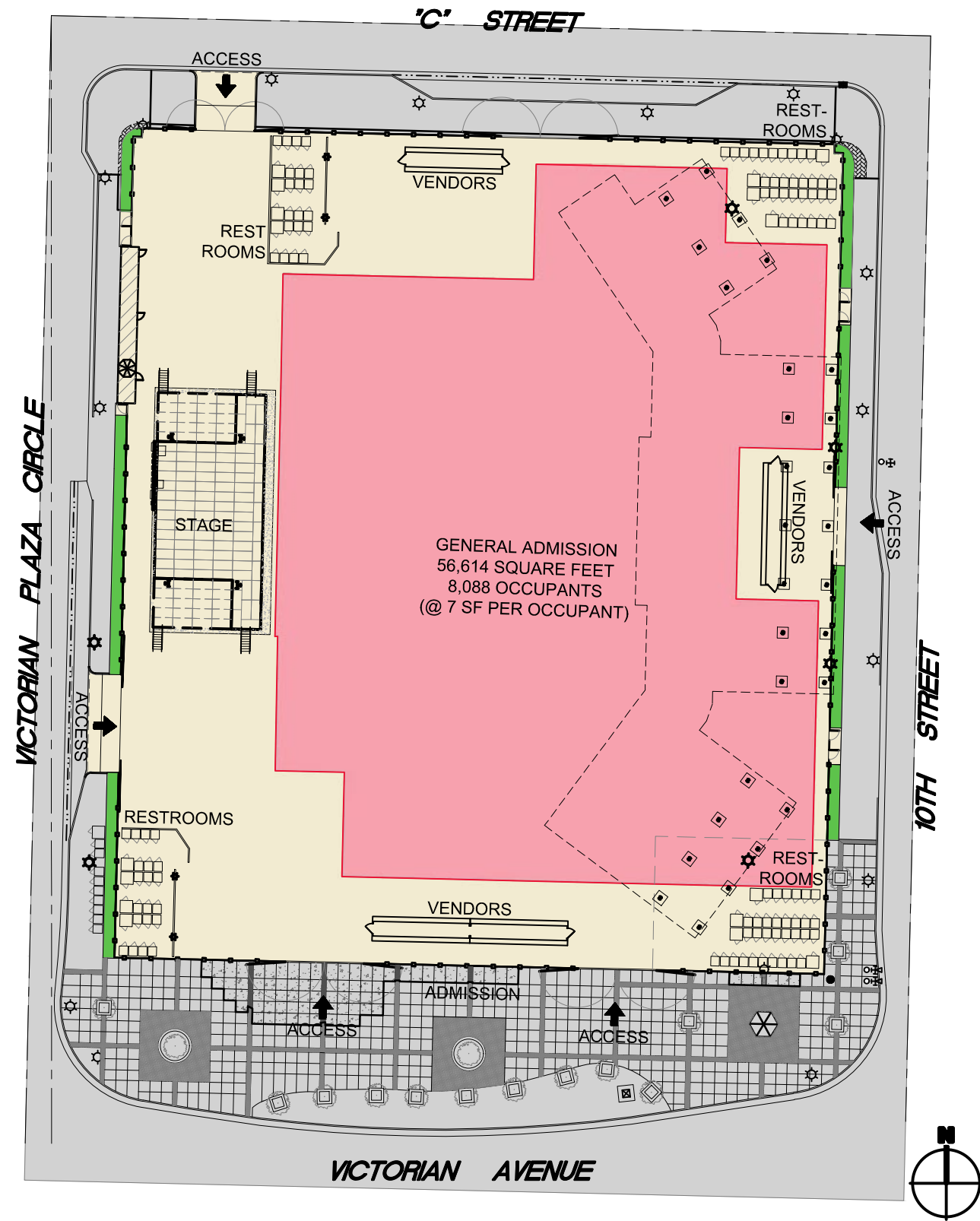

SEATING TABULATION	
GENERAL ADMISSION:	= 8,088 GA
OVERALL TOTAL SEAT COUNT	= 8,088 SEATS
INSIDE VENUE	= 120
OUTSIDE VENUE	= 30
TOTAL	= 150

RESTROOMS	
INSIDE VENUE	= 120
OUTSIDE VENUE	= 30
TOTAL	= 150